

LIGHT & ENERGY

TF IM5.5Y



FEATURES

- Zinc plated telescopic mast
- Manual winch raise/lower
- Wind proof up to 80Km/h
- Two axes manually adjustable floodlights
- Bunded base
- Trolley with wheels and handles
- On/off switches one for each lamp
- 2 adjustable stabilisers, extensible
- Safety lock
- Super silenced
- Single point lifting eye and forklift pockets
- Meets EC directives for noise and safety

	TF IM5.5Y L-4X150	TF IM5.5Y L-4X240	TF IM5.5Y J-4X400
Lamps type and numbers	LED N° 4	LED N° 4	METAL HALIDE N° 4
Illuminated area	2000 mq	2500 mq	1800 mq
Lux average	30	42	19
Total lumen	89900 lm	153480 lm	140000 lm
Lamps power	150W	240W	400W
Color temp.	5000 K	5000 K	5500 K

TRASPORTO



	ON BASE	SITE TOW TRAILER
TRUCK 13.60 m	22 towers	14 towers
CONTAINER 12 m	20 towers	12 towers
CONTAINER 5 m	8 towers	6 towers



AVAILABLE LAMPS

- TF IM5.5Y L-4X150: 4 LED
- TF IM5.5Y L-4X240: 4 LED
- TF IM5.5Y J-4X400: 4 METAL HALIDE



OPTIONS ON REQUEST

- Switch for external power supply



VERSIONS ON REQUEST

- /

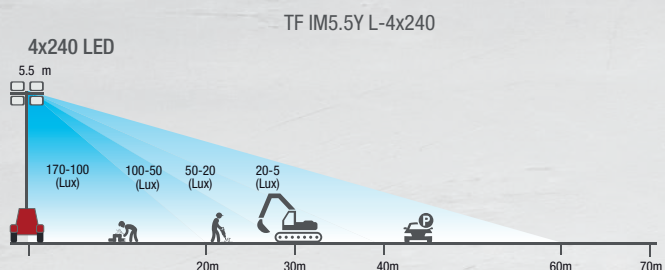
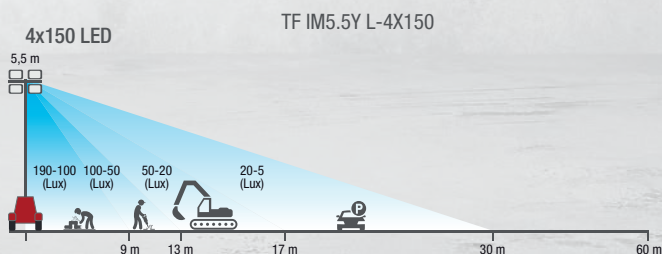
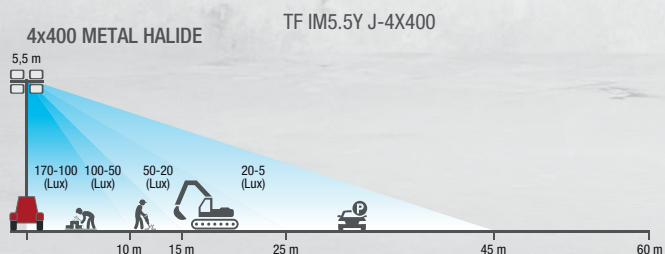

DIMENSIONS

TF IM5.5Y WITH RAISED GALVANIZED POLE

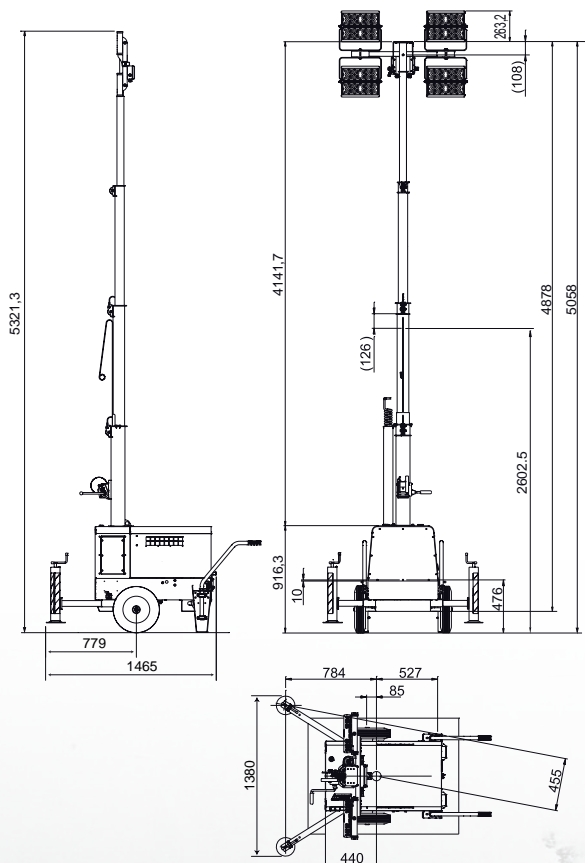

TF IM5.5Y WITH CTV

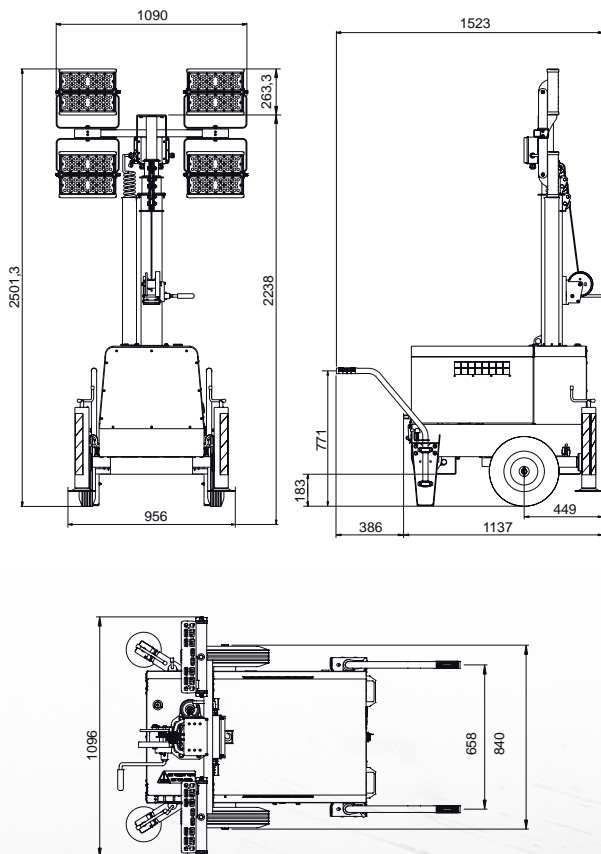

TF IM5.5Y ON BASE

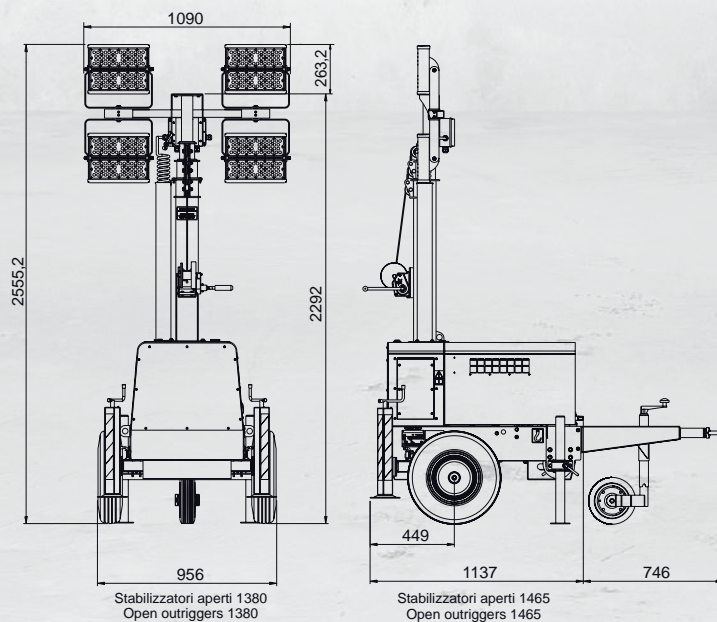

TECHNICAL DATA

LIGHTS AND MAST	
LAMP TYPE:	4X150 W - LED 4X240 W - LED 4X400 W - METAL HALIDE
MAST ROTATION:	/
MAST:	TELESCOPIC - MANUAL
GENERAL CHARACTERISTICS	
WIND LOAD STABILITY:	UP TO 80 km/h
TANK CAPACITY:	23 l
RUNNING TIME:	44h (LED) 32h (METAL HALIDE) 19h GENERATOR
IP PROTECTION:	IP 23 (IP 55 LAMPS)
ACOUSTIC POWER:	LwA = 93 dBA LpA = 68 dBA @ 7 m
STABILIZERS:	2 ADJUSTABLE EXTENSIBLE
WEIGHT (DRY):	335 kg (ON BASE) 343 kg (ON BASE FOR L 4x240)
4-STROKE DIESEL ENGINE, DIRECT INJECTION, AIR COOLING	
MODEL:	YANMAR L70N
STAND-BY NET POWER:	4.5 kW
PRP NET POWER:	4.1 kW
CYLINDERS / DISPLACEMENT:	1 / 320 cm ³
SPEED:	3000 rpm
FUEL CONSUMPTION:	0.5 ÷ 1.2 l /h (min-max);
BATTERY:	12V - 38Ah
GENERATOR	
ALTERNATOR:	4.2 kVA, SINGLE-PHASE, SYNCHRONOUS, BRUSHLESS, 2 POLS - COS j = 0.9 - INSULATION CLASS = H
OUTPUT POWER SOCKETS:	3.1 kVA (2.8 kW) 230V / 13.5A 50 Hz 1x230V/16A 2P+T CEE 3.1 kVA (2.8 kW) 115V / 27A 50 Hz 1x115/16A 2P+T CEE

GENERAL INFORMATION

COMPLIANCE GENERATING SETS WITH EC DIRECTIVES AND STANDARDS

2006/42 / EC (Machines Directive)
 2014/35 / EU (Low Voltage Directive)
 2014/30 / EU (EMC Directive)
 2000/14 / EC (Directive Acoustic Emission for machines for use outdoors)
 ISO 8528 (Reciprocating internal combustion engine driven alternating current generating sets)



ISO 9001:2015 - Cert. 0192

WARRANTY

All devices are covered by the manufacturer's warranty.

The company reserves the right to change this specification without notice. For further information please contact the sales department.

© MOSA - Viale Europa, 59 - 20090 Cusago (Milano) - Italy - phone +39-0290352.1 - fax + 39-0290390466 E-mail: info@mosa.it Web site: www.mosa.it

